

KTE0079030 KIT SCOCCA SUPERIORE

- coperchio stampante
- supporto interfaccia
- supporto stampante
- guscio superiore
- frame display operatore e cliente
- tappo vano giornale
- boccola
- vite fiscale

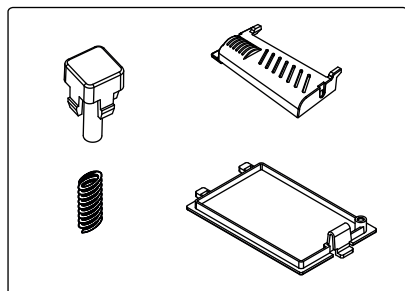

KTE0059030 KIT MINUTERIA

- molla
- leva apertura sportello
- coperchio vano batteria
- tasto di apertura

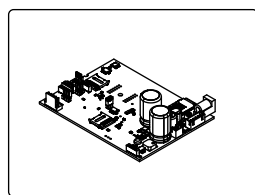

MPZ960
logica

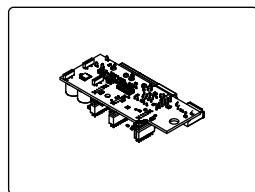

MPZ961
scheda connessioni

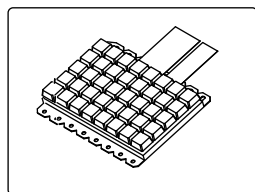

MPZ380X
tastiera
Fustella (IT) MPD433X

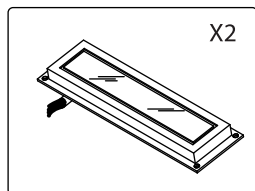

MPZ655
display operatore e cliente 16x2
(incluso adapter display)

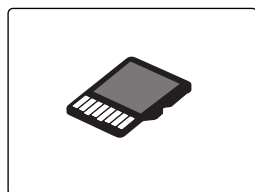

DGFEMRT-DTW
G.E. nativo RT

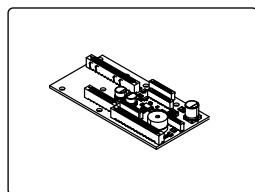

MPZ962
interfaccia tastiera display

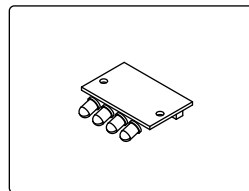

MPZ386
scheda controllo banconote

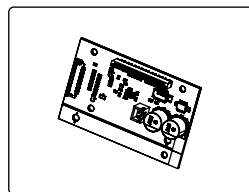

MPZ963
interfaccia stampante

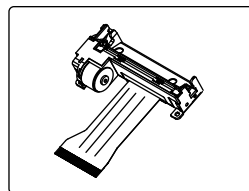

MPG0043
stampante

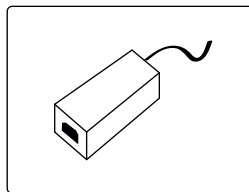

MPQ067
alimentatore

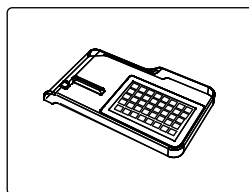

AX1080X1
kit cover di protezione
include tastiera silicónica e istruzioni

CAVETTERIA

- MPM186a
flat, logica <> scheda verifikatore banconote
- MPM186b
flat, logica <> memoria fiscale
- MPM463
cavo ffc, logica <> interfaccia tastiera/display
- MPM435
cavetto ffc, logica <> interfaccia stampante
- MPZ332b
cavo alimentatore
- MPM177p
cavetto ffc, display operatore <> interfaccia display
- MPM177
cavetto ffc, display cliente <> interfaccia display



Listino Parti Ricambi Sarema X1 RT

COD	DESCRIZIONE	PREZZO LISTINO U.F
KTE0058030	KIT SCOCCA SUP SAREMA X1/-A COLORE ROSSO	€ 33,60
KTE0059030	KIT MINUTERIA	
AX1080X1	COP. PVC ECR, COP. SILICONICA, ISTRUZ D'USO	€ 56,00
DGFEMRT-DTW	GIORNALE ELETTRONICO CERTIF VERS.MICRO SD	€ 88,00
MPQ067	ALIMENTATORE PER ECR VERS LC, 9Vcc,3,5A, 32W	€ 50,00
MPZ380S	TASTIERA PER MOD DS380/STORE/VSTORE	€ 66,46
MPZ655	DISPLAY OPERATORE/CLIENTE	€ 36,00
MPZ961	PANNELLO CONNETTORI PER ECR NATIVO	€ 87,60
MPZ962V50	SCHEDA INTERF. TASTIERA/DISPLAY	€ 100,00
MPZ386	SCHEDA CONTROLLO BANCONOTE A LED	€ 51,80
MPZ963	INTERFACCIA STAMPANTE	€ 55,00
MPZ960	LOGICA (VERS NATIVA)	€ 275,00
MPG0043	STAMPANTE	€ 84,00
MPM177	FLAT DISPLAY CL - INTERFACCIA DISPLAY	€ 6,00
MPM177P	FLAT DISPLAY OP- INTERFACCIA DISPLAY	€ 6,00
MPM186A	FLAT LOGICA- LETTORE BANCONOTE	€ 6,00
MPM186B	FLAT LOGICA- MEMORIA FISCALE	€ 6,00
MPM463	FLAT LOGICA - INTER TAST/DISPLAY	€ 6,00
MPM435	FLAT LOGICA - INTER STAMP.	€ 6,00
MPM332B	CAVO ALIMENTAZIONE	€ 6,00